

PERMIT

CITY OF NAPOLEON - BUILDING DEPARTMENT
 255 West Riverview Avenue, Napoleon, Ohio 43545 - 419-592-4010

Permit No. 730-77 Issued 5/26/77
date

Job Location 120 De Rome Drive
address

Lot 16 Northcrest Addition
sub-div or legal discript

Issued By Ronald D. Sonnenberg
building official

Owner Terry Lee Spiess 599-1835
name tel.

Address 120 Derome Drive

Agent Self Same
builder-eng.-etc. tel.

Address Same

Description of Use Accessory Building

Residential XX(1)
no. dwelling units

Commercial _____ Industrial _____

New XXX Add'n. _____ Alter _____ Remodel _____

Mixed Occupancy _____

Change of Occupancy _____

Estimated Cost \$ 300.00

FEES	BASE	PLUS	TOTAL	
<input checked="" type="checkbox"/> BUILDING	\$3.00	---	\$3.00	
<input type="checkbox"/> ELECTRICAL	/			
<input type="checkbox"/> PLUMBING				
<input type="checkbox"/> MECHANICAL				
<input type="checkbox"/> DEMOLITION				
<input checked="" type="checkbox"/> ZONING		---	---	---
<input type="checkbox"/> SIGN		/		
WATER TAP				
SEWER TAP				
TEMP. ELECT.				
ADDITIONAL PLAN REVIEW		Struct. _____ hrs	Elect. _____ hrs	
TOTAL FEES.....			\$3.00	
LESS MIN. FEES PAID _____ <small>date</small>			-0-	
BALANCE DUE.....			\$3.00	

ZONING INFORMATION

district "B"	lot dimensions 85' x 120'	area 10,200sq'	front yd n/a	side yds 16'W 60'E OK	rear yd Min. 15'OK
max hgt 10'/	no pkg spaces no additional	no ldg spaces n/a	max cover 45% OK	petition or appeal req'd n/a	date appr -----

WORK INFORMATION:

Size: Length 10' Width 9' Stories 1 Ground Floor Area 90sq'

Height _____ Building Volume (for demo. permit) _____ cu. ft.

Electrical: _____
brief description

Plumbing: _____
brief description

Mechanical: _____
brief description

Sign: _____ Dimensions _____ Sign Area _____
type

Additional Information: Shall provide provisions for the prevention of wind uplift.

Date 5-26-77 Applicant Signature Terry Lee Spiess
owner/agent

CITY OF NAPOLEON
BUILDING INSPECTION DEPARTMENT
APPLICATION FOR CONSTRUCTION PERMIT
(PLEASE PRINT OR TYPE)

730-77

\$ 3.00

The undersigned hereby makes application for the construction, installation, replacement or alteration as herein specified, agreeing to do all such work in strict accordance with the City of Napoleon's Building Code for 1, 2 and 3 Family Buildings.

Owner's Name TERRY LEE SPIESS Address 120 DeRome Drive

Builder's Name TERRY SPIESS Address 120 DeRome Tel. 599-1835

LOT INFORMATION: (Not required for roofing or siding job.)

Location of Project 120 DeRome Drive Lot # 16

Subdivision Northerest Addition Lot Area 10,200 Sq. Ft.

Yard Set Back: Front 28' Rear 65' Left Side 18'

Right Side 15' Zoning District B

BUILDING INFORMATION:

Single Double Multiple New Construction

Addition Remodel Attached Garage

Detached Garage Accessory Building Replacement

Brief Description of Work: 9x12 Steel Utility Shed
anchored with eye bolts to cement

Size: Length 9' Width 10' No. of Stories 1

Floor Area: 1st Floor 90 Sq. Ft. 2nd Floor Sq. Ft.

3rd Floor Sq. Ft. Basement Sq. Ft.

Unfinished Attic Garage

Foundation: Piers Full Basement Part Basement

Concrete 4" Thickness Block Size

Walls: Frame Block Brick Other

Specific Type of Exterior Siding Steel

APPLICATION FOR PERMIT SHALL BE ACCOMPANIED BY TWO COMPLETE SETS OF PLANS INCLUDING: ELEVATIONS, FLOOR PLANS, CROSS SECTIONS AND PLOT PLAN. IF ADDITIONS OR REMODELING, SHOW ALL EXISTING STRUCTURES AND THEIR SIZE AND LOCATION. ALL PLANS SHALL BE DRAWN TO SCALE.

ESTIMATED COST OF COMPLETED PROJECT: \$300

DATE 5-24-77 APPLICANT'S SIGNATURE Terry Lee Spiess
OWNER-BUILDER-AGENT

CITY OF NAPOLEON
BUILDING DEPT.

Plan Approval

By *Bob.* Date 5/26/74

DeRome Drive

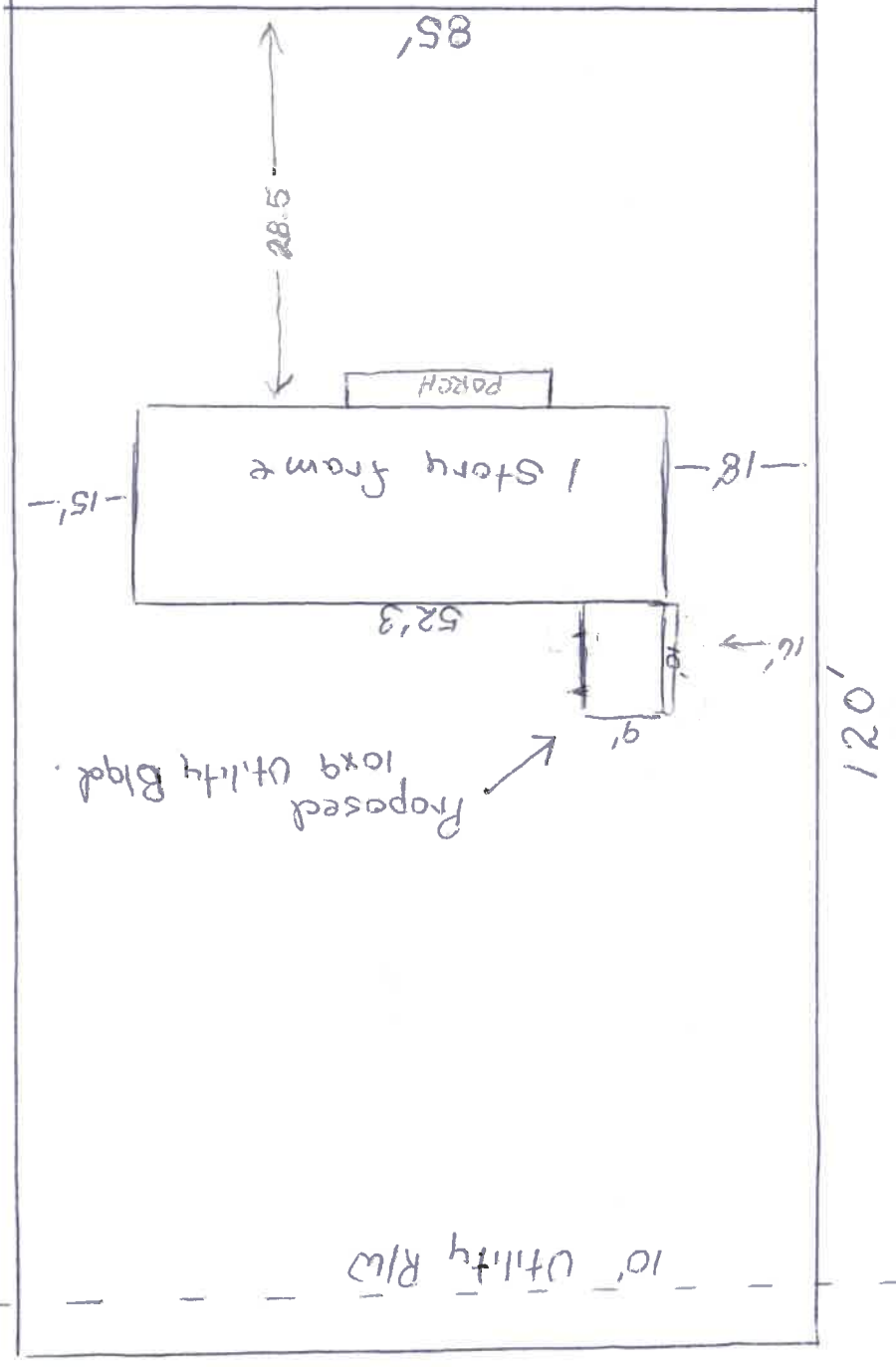

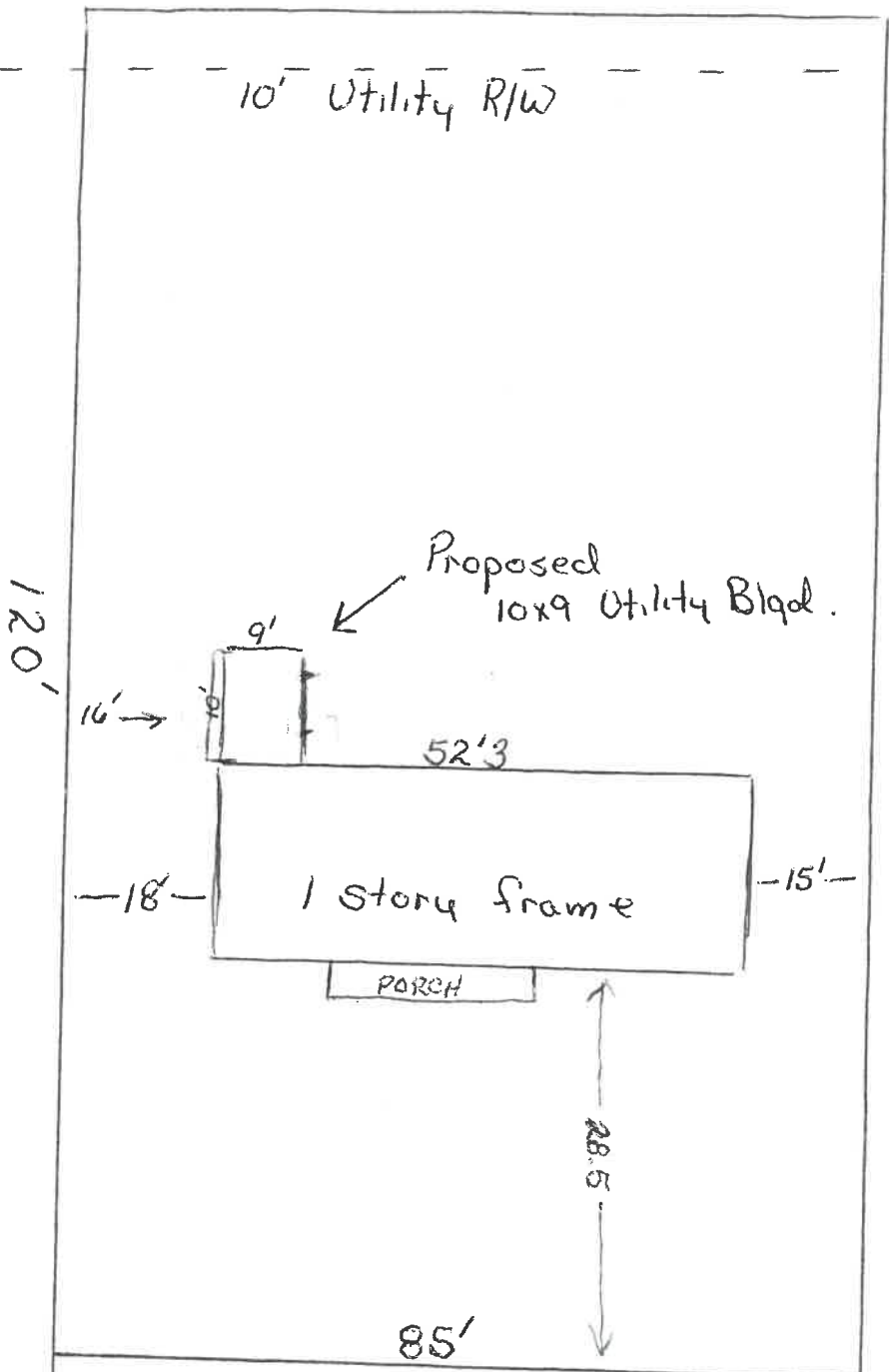

DeRome Drive

CITY OF NAPOLEON
BUILDING DEPT.

Plan Approval

By *Red.* Date *5/26/21*

